

POLYMAR BUILT UP ROOFING

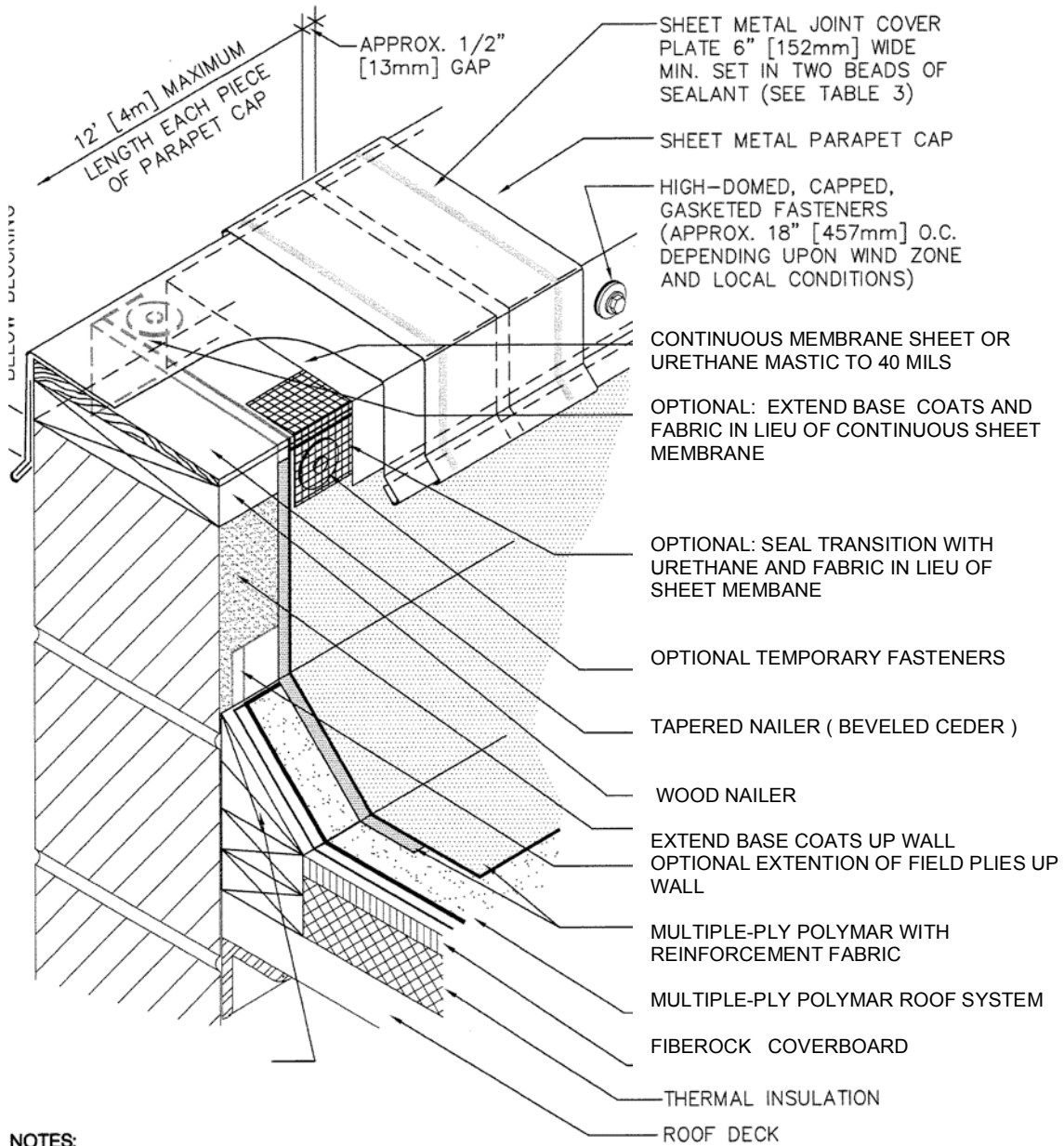

NOTES:

1. THIS DETAIL SHOULD BE USED ONLY WHEN THE ROOF IS SUPPORTED BY THE WALL.
2. ATTACH NAILER WITH SUITABLE FASTENERS.
3. IF WOOD NAILERS ARE NOT USED, A URETHANE CANT CAN BE FABRICATED ON SITE. MIN 3" GIRTH TAPERING 1/2"-0 AT TOP AND BOTTEM.

**ADUREL
POLYMAR
ROOFING SYSTEMS**

PARAPET WALL FLASHING

APW-1